

DOUBLE TEE

Strand Pattern Designation

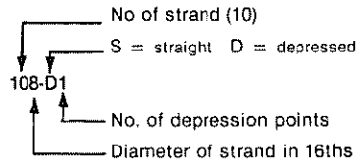

Safe loads shown include dead load of 10 psf for untopped members and 15 psf for topped members. Remainder is live load. Long-time cambers include superimposed dead load but do not include live load.

8'-0" x 32"
Normal Weight Concrete

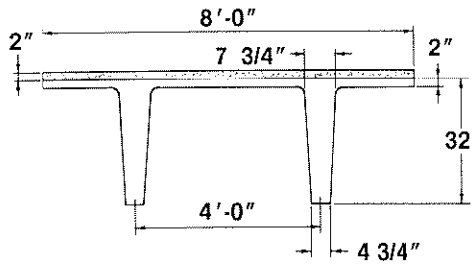

Section Properties

	Untopped	Topped
A =	567 in. ²	—
I =	55,464 in. ⁴	71,886 in. ⁴
Y _b =	21.21 in.	23.66 in.
Y _t =	10.79 in.	10.34 in.
Z _b =	2615 in. ³	3038 in. ³
Z _t =	5140 in. ³	6952 in. ³
wt =	591 plf	791 plf
	74 psf	99 psf
V/S =	1.79 in.	

Key

- 182 — Safe superimposed service load, psf
- 1.3 — Estimated camber at erection, in.
- 1.5 — Estimated long-time camber, in.

$f'_c = 5000$ psi
 $f_{pu} = 270,000$ psi

8DT32

Table of safe superimposed service load (psf) and cambers

No Topping

Strand Pattern	e_e e_c	Span, ft.																				
		50	52	54	56	58	60	62	64	66	68	70	72	74	76	78	80	82	84	86	88	
128-D1	12.04	182	164	147	133	120	108	98	88	79	71	64	57	51								
	17.96	1.3	1.3	1.3	1.3	1.3	1.3	1.3	1.3	1.2	1.1	1.0	0.9	0.7								
148-D1	9.71		193	175	159	144	131	119	108	98	89	80	73	65	58							
	17.71		1.5	1.5	1.6	1.6	1.6	1.6	1.6	1.5	1.5	1.4	1.3	1.2	1.0							
168-D1	8.21				184	168	153	139	127	116	105	95	86	77	69	62	55					
	17.46				1.7	1.8	1.8	1.9	1.9	1.9	1.9	1.8	1.7	1.6	1.5	1.4	1.2					
188-D1	6.82						173	157	143	130	118	107	98	88	80	72	65	58				
	17.21						1.9	2.0	2.0	2.1	2.1	2.1	2.1	2.0	1.9	1.8	1.7	1.5				
208-D1	5.71											120	109	100	91	82	74	67	61	55		
	16.96											2.3	2.3	2.3	2.2	2.2	2.1	1.9	1.7	1.5		
228-D1	4.80																92	84	76	69	63	56
	16.71																2.4	2.3	2.3	2.1	2.0	1.8

8DT32 + 2

Table of safe superimposed service load (psf) and cambers

2" Normal Weight Topping

Strand Pattern	e_e e_c	Span, ft.																				
		44	46	48	50	52	54	56	58	60	62	64	66	68	70	72	74	76				
108-D1	15.31	200	176	155	137	121	106	93	81	71	61											
	18.21	1.0	1.0	1.0	1.1	1.1	1.1	1.1	1.1	1.1	1.0	1.0										
128-D1	12.04			198	176	157	140	125	111	98	87	77	68									
	17.96			1.2	1.3	1.3	1.3	1.3	1.3	1.3	1.3	1.3	1.2									
148-D1	9.71					188	169	152	136	122	109	98	87	76								
	17.71					1.5	1.5	1.6	1.6	1.6	1.6	1.6	1.5	1.5								
168-D1	8.21						198	178	161	145	131	118	106	93	81	70						
	17.46						1.6	1.7	1.8	1.8	1.9	1.9	1.9	1.9	1.8	1.7						
188-D1	6.82									167	151	137	122	108	96	84	74					
	17.21									1.9	2.0	2.0	2.1	2.1	2.1	2.1	2.0					
208-D1	5.71																110	98	87	76		
	16.96																2.3	2.3	2.3	2.2		

Bold type — Capacity governed by stresses, others governed by flexural strength

Values below heavy line require release strengths higher than 3500 psi.