

Strand Pattern Designation

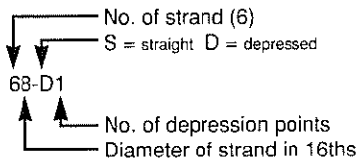

Safe loads shown include dead load of 10 psf for untopped members and 15 psf for topped members. Remainder is live load. Long-time cambers include superimposed dead load but do not include live load.

- Key**
168 — Safe superimposed service load, psf
0.2 — Estimated camber at erection, in.
0.3 — Estimated long-time camber, in.

DOUBLE TEE

8'-0" x 16"
Lightweight Concrete

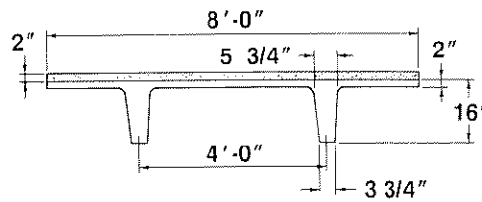

Section Properties

Untopped Topped

A	=	325 in. ²	—
I	=	6,634 in. ⁴	10,094 in. ⁴
y _b	=	11.93 in.	13.99 in.
y _t	=	4.07 in.	4.01 in.
Z _b	=	556 in. ³	721 in. ³
Z _t	=	1,630 in. ³	2,517 in. ³
wt	=	260 pif	460 pif
		33 psf	58 psf
V/S	=	1.29 in.	

$f'_c = 5,000$ psi
 $f_{pu} = 270,000$ psi

8LDT16

Table of safe superimposed service load (psf) and cambers

No Topping

Strand Pattern	e _e e _c	Span, ft.																					
		16	18	20	22	24	26	28	30	32	34	36	38	40	42	44	46	48	50	52	54	56	
28-S	9.93	168	131	102	80	63	50	40	31														
	9.93	0.2	0.3	0.3	0.4	0.4	0.5	0.5	0.5														
48-S	8.93				167	137	113	94	78	66	56	47	40	33									
	8.93				0.8	0.9	1.0	1.2	1.3	1.4	1.4	1.5	1.5	1.5									
68-S	5.93				193	158	131	110	92	78	66	57	48	41	35	30							
	5.93				0.8	0.9	1.0	1.2	1.3	1.4	1.4	1.5	1.5	1.5	1.5	1.4							
68-D1	5.93						185	156	133	114	98	85	73	64	55	48	42	37	32				
	9.43						1.4	1.6	1.8	2.0	2.2	2.4	2.5	2.7	2.8	2.8	2.9	2.9	2.8				
88-D1	3.93																59	52	46	41	36	32	
	9.18																3.7	3.8	3.9	3.9	3.9	3.8	

8LDT16 + 2

Table of safe superimposed service load (psf) and cambers

2" Normal Weight Topping

Strand Pattern	e _e e _c	Span, ft.																					
		16	18	20	22	24	26	28	30	32	34	36	38	40	42	44	46	48					
28-S	9.93	175	133	99	74	55	41																
	9.93	0.2	0.3	0.3	0.4	0.4	0.5																
48-S	8.93				176	140	113	91	74	59	48	38											
	8.93				0.8	0.9	1.0	1.2	1.3	1.4	1.4	1.5											
68-S	5.93				172	140	115	94	77	63	52	42											
	5.93				0.9	1.0	1.2	1.3	1.4	1.4	1.5	1.5											
68-D1	5.93						195	162	135	114	96	80	68	57	47	39							
	9.43						1.4	1.6	1.8	2.0	2.2	2.4	2.5	2.7	2.8	2.8							
88-D1	3.93																52	41					
	9.18																3.7	3.8					

Strength based on strain compatibility; bottom tension limited to $12\sqrt{f'_c}$; see pages 2-3-2-6 for explanation. Shaded values require release strengths higher than 3500 psi.