

**3.4 Double-Tee Load Tables (cont.)**

**3 Strand Pattern Designation**

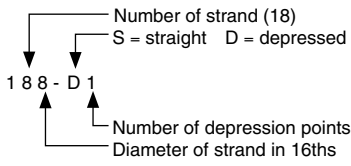

**10'-0" x 32" Normalweight Concrete**

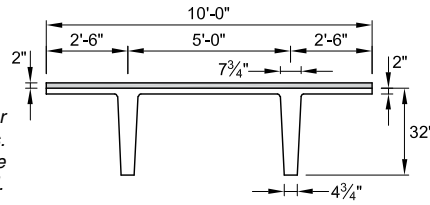

**Section Properties**  
No Topping      2 in. Topping

A = 615 in. <sup>2</sup>	—
I = 59,720 in. <sup>4</sup>	77,118 in. <sup>4</sup>
y <sub>b</sub> = 21.98 in.	24.54 in.
y <sub>t</sub> = 10.02 in.	9.46 in.
S <sub>b</sub> = 2717 in. <sup>3</sup>	3143 in. <sup>3</sup>
S <sub>t</sub> = 5960 in. <sup>3</sup>	8152 in. <sup>3</sup>
wt = 641 lb/ft	891 lb/ft
DL = 64 lb/ft <sup>2</sup>	89 lb/ft <sup>2</sup>
V/S = 1.69 in.	

Safe loads shown include dead load of 10 lb/ft<sup>2</sup> for untopped members and 15 lb/ft<sup>2</sup> for topped members. Remainder is live load. Long-time cambers include superimposed dead load but do not include live load.

- Key**  
189 – Safe superimposed service load, lb/ft<sup>2</sup>  
1.2 – Estimated camber at erection, in.  
1.5 – Estimated long-time camber, in.

- $f'_c = 5000$  psi  
 $f_{pu} = 270,000$  psi  
1/2-in.-diameter regular strand

Check with regional producers for availability.

**10DT32**

**Table of safe superimposed service load, lb/ft<sup>2</sup>, and cambers, in.**

**No Topping**

Strand pattern	y <sub>s</sub> (end) y <sub>s</sub> (center) in.	Span, ft																															
		44	46	48	50	52	54	56	58	60	62	64	66	68	70	72	74	76	78	80	82	84	86	88	90	92	94	96	98	100	102		
		128-S	7.00 7.00	189	169	152	136	123	110	99	90	81	73	65	59	53	47	42	37	33	29	25											
148-S	8.00 8.00	194	174	157	142	128	116	105	95	86	78	71	64	58	52	47	42	38	34	30	26												
168-S	9.00 9.00	194	175	158	144	130	118	108	98	89	81	74	67	61	55	50	45	41	36	33	29	26											
188-S	10.00 10.00	190	173	157	143	130	118	108	99	90	82	75	68	62	57	51	47	42	38	34	31	27											
188-D1	14.39 4.00										132	122	112	103	95	88	81	74	68	63	58	53	49	44	41	37	34	30	27				
208-D1	15.50 4.25																																

**10DT32 + 2**

**Table of safe superimposed service load, lb/ft<sup>2</sup>, and cambers, in.**

**2 in. Normalweight Topping**

Strand pattern	y <sub>s</sub> (end) y <sub>s</sub> (center) in.	Span, ft																																
		44	46	48	50	52	54	56	58	60	62	64	66	68	70	72	74	76	78	80	82	84	86	88										
		128-S	7.00 7.00	187	166	147	131	116	103	92	81	72	63	55	47	38	30																	
148-S	8.00 8.00	193	172	153	137	122	109	98	87	78	68	58	49	40	32	25																		
168-S	9.00 9.00	193	173	155	139	125	112	100	88	78	68	58	49	41	33	26																		
188-S	10.00 10.00																																	
188-D1	14.39 4.00																																	
208-D1	15.50 4.25																																	

Strength is based on strain compatibility; bottom tension is limited to 12√f<sub>c</sub>; see pages 3–8 through 3–11 for explanation. Shaded values require release strengths higher than 3500 psi.