

Design Aid 3.12.5 Partial Interaction Curves for Precast, Prestressed Solid and Sandwich Wall Panels

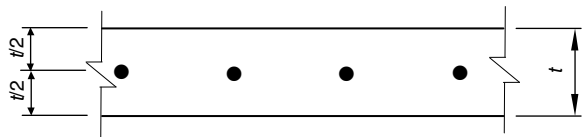

t, in.	Full interaction curve data						
	ϕP_o	Partially developed strand force			Fully developed strand force		
		ϕP_{nb}	ϕM_{nb}	ϕM_c	ϕP_{nb}	ϕM_{nb}	ϕM_c
4	129	46	5.3	0.9	22	4	2.2
6	194	69	11.9	2.0	33	9	5.0
8	259	92	21.2	3.6	45	16	9.0
10	323	115	33	5.6	56	25	14.0

Units for ϕP are kip, units for ϕM are kip-ft.
Values are for 1 ft width.

Curves based on minimum prestress of 225 psi normalweight concrete

$f'_c = 5000$ psi, normalweight

$f_{pu} = 270,000$ psi

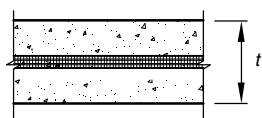

Fully composite sandwich panel

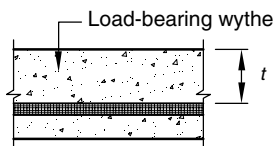

Partially composite or non-composite

Partially developed strand

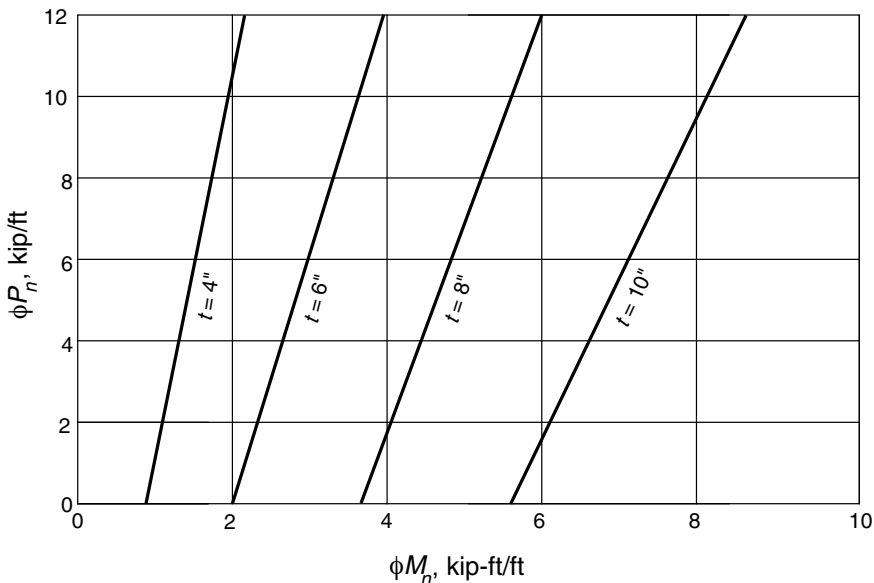

Fully developed strand

