

3.5 Pretopped Double-Tee Load Tables (cont.)

Strand Pattern Designation

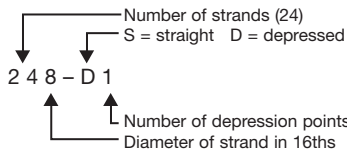

These components are typically used in parking structures. Loads do not include any superimposed dead loads. Loads shown are live load. Long-term cambers do not include live load.

- Key
 169 – Superimposed service load capacity, lb/ft²
 0.3 – Estimated camber at erection, in.
 0.4 – Estimated long-time camber, in.

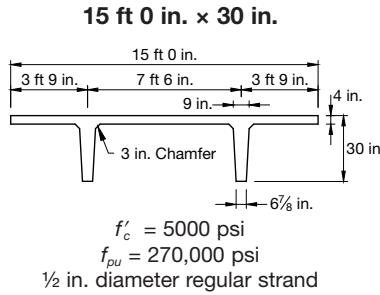

		Section Properties	
		Normalweight	Lightweight
A	=	1133 in. ²	1133 in. ²
I	=	78,625 in. ⁴	78,625 in. ⁴
y _b	=	22.75 in.	22.75 in.
y _t	=	7.25 in.	7.25 in.
S _b	=	3457 in. ³	3457 in. ³
S _t	=	10,838 in. ³	10,838 in. ³
wt	=	1150 lb/ft	905 lb/ft
DL	=	79 lb/ft ²	60 lb/ft ²
V/S	=	2.42 in.	2.42 in.

Check with regional producers for availability.

15DT30

Table of superimposed service load capacity, lb/ft², and cambers, in. Normalweight—no topping

Strand pattern	y _s in.	Span, ft																																											
		30	32	34	36	38	40	42	44	46	48	50	52	54	56	58	60	62	64	66	68	70	72	74	76	78	80	82																	
88-S	7.00	169	141	118	99	83	69	57	47	38	30																																		
		0.3	0.3	0.3	0.3	0.3	0.3	0.2	0.2	0.2	0.1																																		
		0.4	0.4	0.4	0.4	0.4	0.4	0.3	0.3	0.2	0.1																																		
128-S	5.83																	189	164	142	123	107	93	81	70	60	51	44	37	30															
																		0.6	0.7	0.7	0.7	0.7	0.7	0.7	0.7	0.7	0.6	0.5	0.4	0.3															
																		0.9	0.9	1.0	1.0	1.0	1.0	1.0	1.0	0.9	0.8	0.7	0.6	0.4															
168-S	5.69																											184	163	144	127	113	100	88	78	68	60	53	46	39	34	29			
																												1.1	1.2	1.2	1.3	1.3	1.3	1.3	1.3	1.2	1.1	1.0	0.9	0.8	0.6				
																												1.5	1.6	1.7	1.8	1.8	1.8	1.8	1.8	1.7	1.5	1.4	1.2	1.0	0.7				
208-S	5.95																											190	170	152	136	122	109	98	87	78	70	62	55	49	43	37	32	26	
																												1.6	1.7	1.8	1.8	1.9	1.9	1.9	1.9	1.9	1.9	1.9	1.8	1.8	1.6	1.5	1.3	1.1	0.8
																												2.2	2.3	2.4	2.5	2.5	2.6	2.6	2.6	2.6	2.6	2.6	2.6	2.5	2.4	2.2	2.0	1.7	1.3
248-S	6.42																																					65	58	53	47	41	35	29	
																																						2.4	2.3	2.2	2.1	1.9	1.7	1.4	
																																						3.2	3.1	3.0	2.8	2.6	2.2	1.8	

15LDT30

Table of superimposed service load capacity, lb/ft², and cambers, in. Lightweight—no topping

Strand pattern	y _s in.	Span, ft																																													
		30	32	34	36	38	40	42	44	46	48	50	52	54	56	58	60	62	64	66	68	70	72	74	76	78	80	82	84	86	88	90															
88-S	7.00	183	155	132	113	97	83	71	61	52	44	37	31	25																																	
		0.4	0.5	0.5	0.5	0.5	0.6	0.6	0.5	0.5	0.5	0.4	0.3	0.2																																	
		0.6	0.7	0.7	0.7	0.8	0.8	0.8	0.7	0.7	0.6	0.6	0.4	0.3																																	
128-S	5.83																	177	156	137	121	107	94	83	74	65	57	50	44	38	33	29															
																		1.1	1.2	1.2	1.3	1.3	1.4	1.4	1.4	1.4	1.4	1.3	1.2	1.1	0.9																
																		1.5	1.6	1.7	1.8	1.8	1.9	1.9	2.0	2.0	1.9	1.9	1.7	1.6	1.4	1.2															
168-S	5.69																											198	176	157	141	126	113	102	92	82	74	66	59	53	48	42	37	33	29	25	
																												1.9	2.0	2.1	2.2	2.3	2.4	2.4	2.5	2.5	2.5	2.5	2.5	2.4	2.3	2.1	1.9	1.7	1.4		
																												2.5	2.7	2.8	2.9	3.0	3.1	3.2	3.2	3.3	3.3	3.3	3.3	3.3	3.2	3.1	2.9	2.6	2.2	1.8	
208-S	5.95																											184	166	150	136	123	111	101	92	83	76	68	62	56	51	46	41	37	33	29	26
																												2.8	2.9	3.1	3.2	3.3	3.4	3.5	3.6	3.6	3.6	3.6	3.6	3.6	3.5	3.4	3.3	3.1	2.9	2.6	2.2
																												3.8	4.0	4.1	4.3	4.5	4.6	4.7	4.7	4.8	4.8	4.7	4.7	4.6	4.6	4.5	4.3	4.1	3.8	3.4	2.9
248-S	6.42																																					42	38	35	32	29					
																																						4.4	4.2	4.0	3.8	3.5					
																																						5.6	5.4	5.2	4.9	4.5					

Strength is based on strain compatibility; bottom tension is limited to $12\sqrt{f'_c}$; see pages 3–8 through 3–11 for explanation. Shaded values require release strengths higher than 3500 psi.