

**REGIONAL PRODUCTS**

Northeast Bulb-Tees

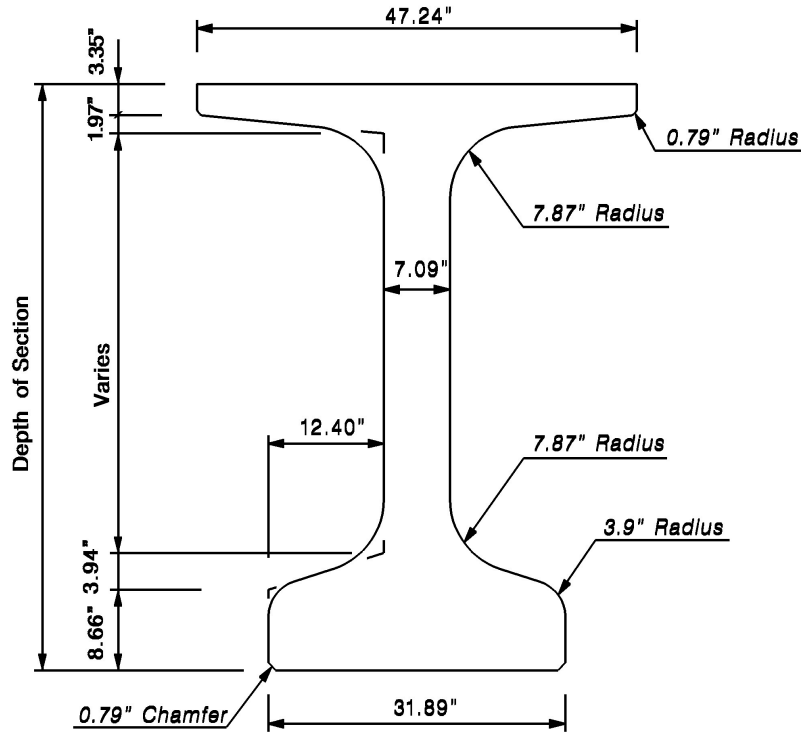

*Typical Bulb-Tee Cross Section*

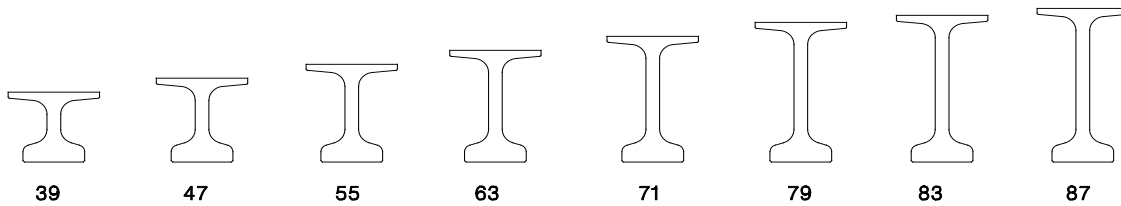

Beam Designation	Depth	Area	Centroid to Bottom	Moment of Inertia	Section Modulus (Top)	Section Modulus (Bot.)	Weight
	in.	in <sup>2</sup>	in.	in <sup>4</sup>	in <sup>3</sup>	in <sup>3</sup>	plf
NEBT 39	39.37	746	19.04	149302	7344	7841	777
NEBT 47	47.24	802	22.64	238436	9691	10532	835
NEBT 55	55.12	858	26.29	352341	12222	13402	894
NEBT 63	62.99	914	29.98	492804	14928	16438	952
NEBT 71	70.87	969	33.69	661602	17796	19638	1009
NEBT 79	78.74	1025	37.43	860400	20828	22987	1068
NEBT 83	82.68	1053	39.30	971643	22400	24724	1097
NEBT 87	86.61	1081	41.19	1091070	24020	26489	1126

*Northeast Bulb-Tee Section Properties for Pretensioned Sections*

With 7.1" wide (180 mm) web

**REGIONAL PRODUCTS**

*Northeast Bulb-Tees*

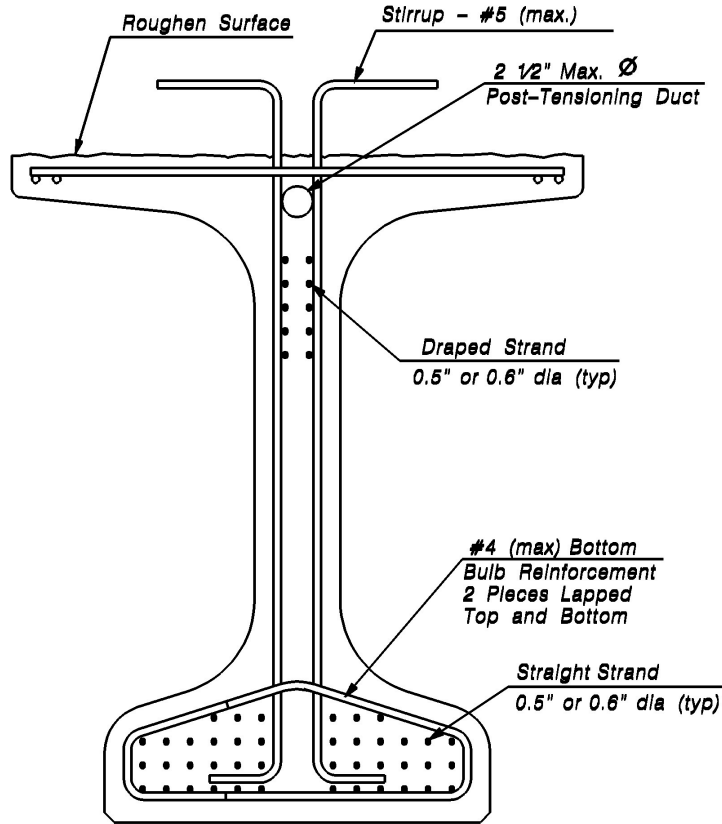

*Typical Section - General Reinforcement Layout*

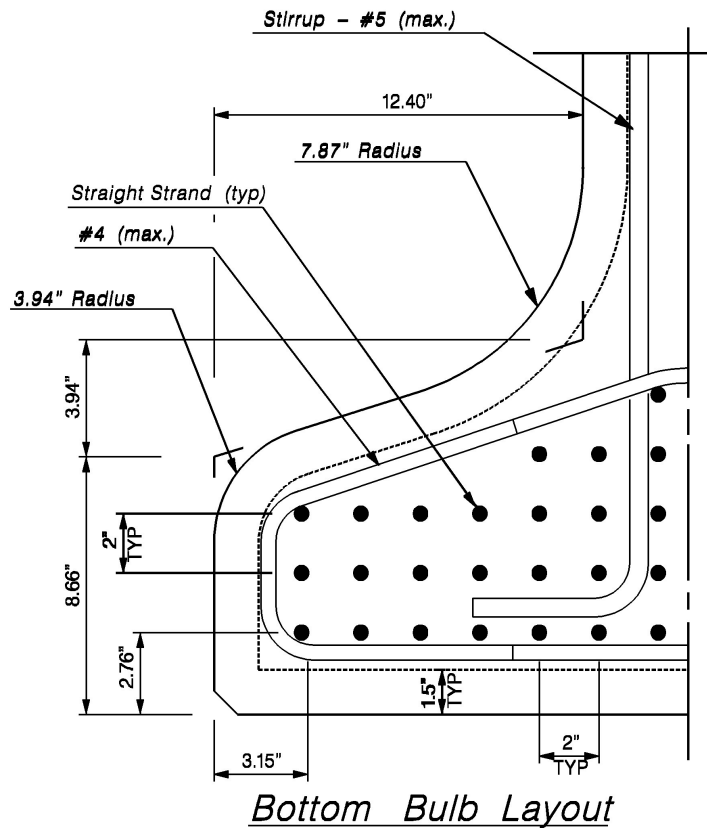

*Bottom Bulb Layout*